

NETTUNO, ITALY
(35 mi. S of Rome)

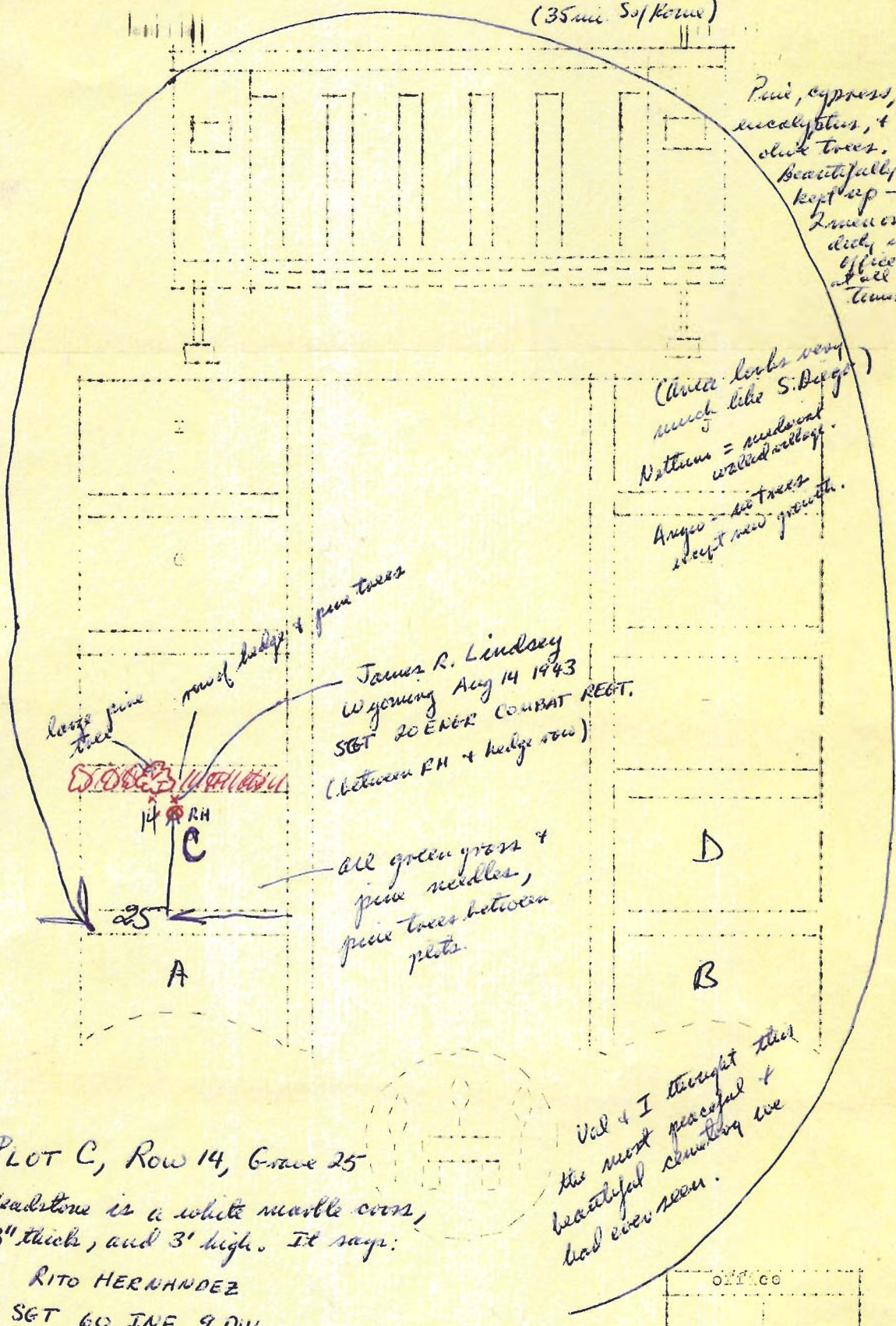

Pine, cypress, acalyptus, & olive trees. Beautifully kept up - 2 men on duty in office at all times.

(Area looks very much like S. Diego)
Nettuno = medieval walled village.
Anger - old trees except new growth.

James R. Lindsey
Wyoming Aug 14 1943
SGT 20 ENR COMBAT REGT.
(between RH + hedge row)

all green grass & pine needles, pine trees between plots.

PLOT C, Row 14, Grave 25
Headstone is a white marble cross, 3" thick, and 3' high. It says:

RITO HERNANDEZ
SGT 60 INF 9 DIV
COLORADO AUG 7 1943
25

(serial number on back)

Val & I thought this the most peaceful & beautiful cemetery we had ever seen.

From US office (Washington)

- ① Lithographic print (color) of area
- ② Grave side photo (To rest of pin only)

